

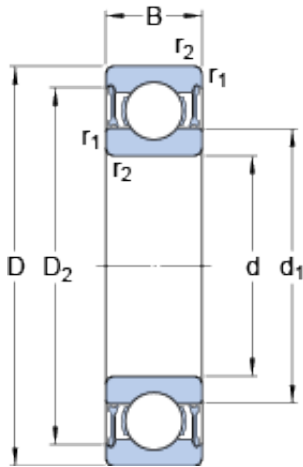

Wuxi NSB Transmission Technology Co.,...



6305-2RZ Bearing 2D drawings and 3D CAD models

25 mm x 62 mm x 17 mm SKF 6305-2RZ deep groove ball bearings

Bearing No. 6305-2RZ

| | |
|---|--------------------------|
| Size | 62x25x17 mm |
| Bore Diameter | 62 mm |
| Outer Diameter | 25 mm |
| Width | 17 mm |
| d | 25 mm |
| D | 62 mm |
| B | 17 mm |
| d ₁ | 36.6 mm |
| D ₂ | 52.7 mm |
| r _{1,2} - min. | 1.1 mm |
| d _a - min. | 32 mm |
| d _a - max. | 36.5 mm |
| D _a - max. | 55 mm |
| r _a - max. | 1 mm |
| Basic dynamic load rating - C | 23.4 kN |
| Basic static load rating - C ₀ | 11.6 kN |
| Fatigue load limit - P _u | 0.49 kN |
| Reference speed | 24000 r/min |
| Limiting speed | 13000 r/min |
| Calculation factor - k _r | 0.03 |
| Calculation factor - f ₀ | 12 |
| Category | Single Row Ball Bearings |
| Inventory | 0.0 |
| Manufacturer Name | SKF |



Wuxi NSB Transmission Technology Co.,...

| | |
|---------------------------------|---|
| Minimum Buy Quantity | N/A |
| Weight / Kilogram | 0 |
| Product Group | B00308 |
| Enclosure | 2 Seals |
| Precision Class | ABEC 1 ISO P0 |
| Maximum Capacity / Filling Slot | No |
| Rolling Element | Ball Bearing |
| Snap Ring | No |
| Internal Special Features | No |
| Cage Material | Steel |
| Enclosure Type | Non-Contact Seal |
| Internal Clearance | C0-Medium |
| Inch - Metric | Metric |
| Long Description | 25MM Bore; 62MM Outside Diameter; 17MM Outer Race Width; 2 Seals; Ball Bearing; ABEC 1 ISO P0; No Filling Slot; No Snap Ring; No Internal Special Features; C0-Medium Internal Clearance; Steel Cage; |
| Other Features | Deep Groove NBR Seal |
| Category | Single Row Ball Bearing |
| UNSPSC | 31171504 |
| Harmonized Tariff Code | 8482.10.50.68 |
| Noun | Bearing |
| Keyword String | Ball |
| Manufacturer URL | http://www.skf.com |
| Weight / LBS | 0.52 |
| Outside Diameter | 2.441 Inch 62 Millimeter |
| Inner Race Width | 0 Inch 0 Millimeter |
| Outer Race Width | 0.669 Inch 17 Millimeter |
| Bore | 0.984 Inch 25 Millimeter |



Wuxi NSB Transmission Technology Co.,...

| | |
|--------------------------------|---------|
| d_1 | 36.6 mm |
| D_2 | 52.7 mm |
| d_a min. | 32 mm |
| d_a max. | 36.5 mm |
| D_a max. | 55 mm |
| r_a max. | 1 mm |
| Basic dynamic load rating C | 23.4 kN |
| Basic static load rating C_0 | 11.6 kN |
| Fatigue load limit P_u | 0.49 kN |
| Calculation factor k_r | 0.03 |
| Calculation factor f_0 | 12 |
| Mass bearing | 0.23 kg |