

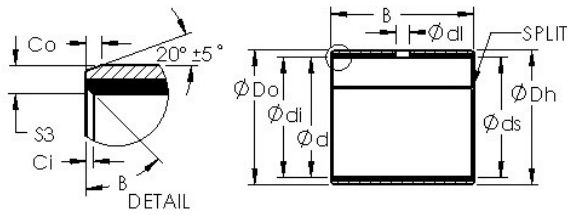

# Wuxi NSB Transmission Technology Co.,...



## AST AST50 88IB56 plain bearings

Bearing No. AST50 88IB56

Bore Diameter	139,7 mm
Bearing Type	straight
Shaft Dia., Nominal (d)	5.5000
Shaft Size (ds) - 5.5	5.4975
Housing Bore Dia. (Dh) - 5.6874	5.6858
Bearing Bore after Mounting (di) - 5.507	5.5002
Average Clearance (Cd)	0.0048
Wall Thickness (S3)	0.095
Bearing Length, Nominal (B)	3.500
Bearing Length Tolerance (B tol.) - +.010 / -0.010	+0.010 / 0.010
OD Chamfer Length (Co)	0.072
ID Chamfer Angle (B deg.)	30
ID Chamfer Length (Ci)	0.031
Material	Carbon steel shell with PTFE / Fiber lining

AST50 88IB56 Bearing 2D drawings and 3D CAD models