

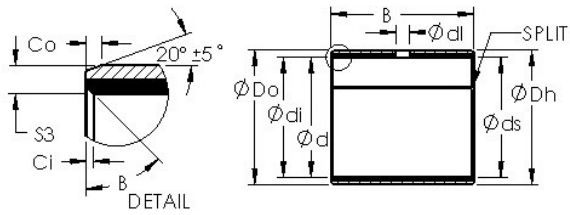

Wuxi NSB Transmission Technology Co.,...



AST AST50 84IB40 plain bearings

Bearing No. AST50 84IB40

Bore Diameter	133,35 mm
Bearing Type	straight
Shaft Dia., Nominal (d)	5.2500
Shaft Size (ds) - 5.25	5.2475
Housing Bore Dia. (Dh) - 5.4374	5.4358
Bearing Bore after Mounting (di) - 5.257	5.2502
Average Clearance (Cd)	0.0048
Wall Thickness (S3)	0.095
Bearing Length, Nominal (B)	2.500
Bearing Length Tolerance (B tol.) - +.010 / -0.010	+.010 / 0.010
OD Chamfer Length (Co)	0.072
ID Chamfer Angle (B deg.)	30
ID Chamfer Length (Ci)	0.031
Material	Carbon steel shell with PTFE / Fiber lining

AST50 84IB40 Bearing 2D drawings and 3D CAD models